

MPT-Hammer head bolts

zinc lamella coating, silver

Field of application

- Hammer head bolts with washer and hexagonal nut for safe fastening of add-on parts in the channel slot of the MPT-Support profiles and consoles

Advantages

- No danger of confusing parts; can be implemented universally for MPT-Profiles Q50, Q80, Q100 and Q150
- Strength class 8.8 for safe transmission of high forces
- Rifled support on the hammer head for safe transmission of the holding force in the fastening groove

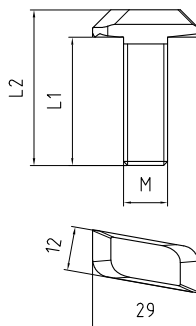

Max. load capacities:

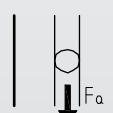
For profile	Size	Max. recommended tensile load F_z [N] 	Max. recommended transverse load $F_Q^{1)}$ [N] 	At tightening torque $T_{inst}^{2)}$ [Nm]
Q50-2.5	M10 x 25	5,000	6,000	40
	M12 x 35	7,000	9,500	65
	M12 x 60			
	M12 x 80			
	M12 x 100			
Q80-2.0	M10 x 25	10,000	6,000	40
	M12 x 35	12,000	9,500	65
	M12 x 60			
Q100-2.5	M10 x 25	6,000	6,000	40
	M12 x 35	8,000	9,500	65
	M12 x 60			
Q100-3.5	M10 x 25	10,000	6,000	40
	M12 x 35	12,000	9,500	65
	M12 x 60			
Q150-2.5	M10 x 25	6,000	6,000	40
	M12 x 35	8,000	9,500	65
	M12 x 60			

Size	Length L1 [mm]	Length L2 [mm]	Part no.	Sales unit	Pack unit	Weight [kg/piece]
M10 x 25	25	32.5	139167	50	pieces	0.058
M12 x 35	35	42.5	139168			0.074
M12 x 60	60	67.5	139169			0.111
M12 x 80 ³⁾	80	88.5	151341	1		0.110
M12 x 100 ³⁾	100	108.5	151342			0.123

¹⁾ Hole tolerance of the bold has been adjusted.

²⁾ Values apply for threads being dry and free of dust, oil and grease.

The MPT-Hammer head bolts are covered with a new type of zinc lamella coating, which has a lower friction coefficient than conventional galvanic coatings. This increases the ease of installation as the required preload force is reached at a much lower tightening torque.

³⁾ Size M12 x 80 and M12 x 100 available on request.