

Single bossed clamps

with connecting socket, without lining, galvanised

Field of application

- Applicable as a pipeline anchor point
- Suitable for fixings in shipbuilding and industrial areas as well as in air-conditioning, ventilation and sanitary areas
- For indoor use

Advantages

- Proven, two-piece single bossed clamp in heavy-duty design
- For bending-resistant fastening at greater distances from the building structure
- Ideal combination when used with pipe nipple and base plate or socket adapter



This product is awarded with the "Gütezeichen Rohrbefestigung" (quality mark of pipe support) and is submitted to controls according to RAL-GZ 655-B

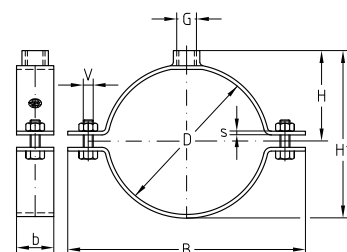

Features

Size	Max. recommended load [N]
¾"-70 mm	2,200
2½"-174 mm	4,400
179-210 mm	5,000

Connecting thread G [inch]	Size		Clamping range [mm]	Part no.	Sales unit	Pack unit	Dimensions [mm]					
	[inch]	[mm]					B	b	H1	H	V	
½	1		31–37	154978	100	pieces	71	20	70	47.5		
		40	38–41	154979			75		74	49.5		
	1¼	42.4	42–46	154980			81		80	52.5		
	1½		47–52	154981	50		87		85	55.0		M6 x 25
		57	53–57	154982			91		90	57.5		
	2		58–63	154983			100		98	61.5		
		70	64–71	154984			105		103	64.0		
	2½		72–78	154931			120	25	112	68.5	M8 x 35	
		83	79–85	154932			126		118	71.5		
	3		85–90	154933			131		123	74.0		
		102	99–104	154934	146		137		81.0	M8 x 40		
	4		108–115	154935	157		148		86.5			
		122	118–123	159190	166		157		91.0			
		125	125–130	154936	172		163		94.0			
	5		133–140	154937	182		173	99.0				
		147	142–148	159191	191		182	103.5				
		152	148–153	159192	196		187	106.0				
		160	154–160	154938	202		193	109.0				
	6		160–169	154939	210		201	113.0				

