

Single bossed clamps with DÄMMGULAST® red, galvanised

Field of application

- Suitable for pipelines with dynamic loads in combination with expansion points
- Suitable for fixings in shipbuilding and industrial areas as well as in air-conditioning, ventilation and sanitary areas and thermal oil pipes
- Attachment of pipelines in increased temperature ranges
- For indoor use

Advantages

- Proven two-piece single bossed clamp
- The 2 locking screws allow adjustment to accommodate a greater variation in pipe diameter
- With **high-temperature resistant DÄMMGULAST® Vibration control lining red**

- The high-quality DÄMMGULAST® section maintains its properties in the **temperature range -60 °C to +225 °C**
- Average sound level improvement up to 24 dB(A)
- Tightening bolts with combination cross-head convenient for power driver
- Tightening bolts secured with captive washers
- Heavy-duty type with high load capacity due to creased shape
- Acoustic insulation, positive-fit liner with wide clip-over edges prevent the lining from slipping out of the pipe clamp
- This product is awarded with the "Gütezeichen Rohrbefestigung" (quality mark of pipe support) and is submitted to controls according to RAL-GZ 655-B



Features

Size	Max. recommended load [N]
3/8"-2"	1,500
70-83 mm	2,200
3"-133 mm	2,900
5"-200 mm	3,500
212-225 mm	5,300

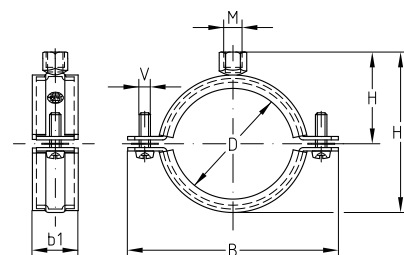

Connecting thread	Size		Clamping range [mm]	Part no.	Sales unit	Pack unit	Dimensions [mm]				
	[inch]	[mm]					B	b1	H1	H	V
M8/M10	3/8		14–20	151532	100	pieces	64	23	55	35.5	M6 x 20
	1/2		21–26	151533			71		61	38.5	M6 x 25
	3/4		26–30	151534			75		65	40.5	
	1		31–38	151535	50	81	71	43.5	M6 x 25		
	1 1/4		40–47	151537		91	81	48.5			
	1 1/2		48–54	151538		100	89	52.5			
		57	54–60	151539		105	94	55.0	M8 x 35		
	2		60–66	151540		111	100	58.0			
		70	68–73	151542		126	109	62.5			
	2 1/2		73–80	151543		131	114	65.0	M8 x 35		
		83	82–87	151544		142	124	70.0			
	3		87–94	151545		146	128	72.0		M8 x 40	
		102	99–104	151546		157	139	77.5			
		110	105–112	151547		166	148	82.0			
	4		112–118	151548			172	154	85.0		



Single bossed clamps can be produced in all other pipe sizes and types according to customer specifications. For use in areas with requirements on the duration of fire resistance, the boundary conditions set out in the fire test report must be observed.

Single bossed clamps with DÄMMGULAST® red, galvanised

Connecting thread	Size		Clamping range [mm]	Part no.	Sales unit	Pack unit	Dimensions [mm]				
	[inch]	[mm]					B	b1	H1	H	V
M8/M10		125	122–128	151549	50	pieces	182	28	164	90.0	M8 x 40
		133	132–137	151550			191		173	94.5	
	5		137–142	151551			196		178	97.0	
		144	142–148	151552			202		184	100.0	
		150	149–156	151553			210		192	104.0	
		160	159–164	151554			218		200	108.0	
	6		164–169	151555			223		205	110.5	
M10/M12	1		31–38	151560	100		81	23	76	48.5	M6 x 25
	1¼		40–47	151562	50		91		86	53.5	
	1½		48–54	151563		100	94		57.5		
		57	54–60	151564		105	99		60.0		
	2		60–66	151565		111	105		63.0		
		70	68–73	151567		126	28	114	67.5	M8 x 35	
	2½		73–80	151568		131		119	70.0		
		83	82–87	151569		142		129	75.0		
		133	132–137	151575		191		178	99.5		M8 x 40
		160	159–164	151579		218	205	113.0			
	6		164–169	151580		223	210	115.5			
			170	169–172	151581		225	212	116.5		
		180	177–183	151582	25		235	223	122.0		
		200	197–203	151583			256	243	132.0		
		212	208–214	151584			284	46	256	138.5	M10 x 40
	8		217–225	151585			295		267	144.0	

 Single bossed clamps can be produced in all other pipe sizes and types according to customer specifications. For use in areas with requirements on the duration of fire resistance, the boundary conditions set out in the fire test report must be observed.