

Single bossed clamps

with DÄMMGULAST® blue, galvanised

Field of application

- Suitable combination for pipelines with dynamic loads with expansion points
- Suitable for fixings in shipbuilding and industrial areas as well as in air-conditioning, ventilation and sanitary areas
- For indoor use

Advantages

- Proven two-piece single bossed clamp
- The 2 locking screws allow adjustments to accommodate a greater variation in pipe diameter
- Vibration control lining DÄMMGULAST® with blue identification stripe: **Fire classification**

B1 according to DIN 4102, no flammable dripping

- Average sound level improvement up to 16.5 dB(A)
- Tightening bolts with combination cross-head convenient for power-driver
- Tightening bolts secured with captive washers
- Heavy-duty type with high load capacity due to creased shape
- Acoustic insulation, positive-fit liner with wide clip-over edges prevent the lining from slipping out of the clamp



This product is awarded with the "Gütezeichen Rohrbefestigung" (quality mark of pipe support) and is submitted to controls according to RAL-GZ 655-B

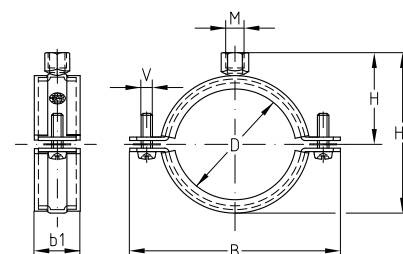

Features

Size	Max. recommended load [N]
3/8"-2"	1,600
70-83 mm	2,200
3"-133 mm	2,900
5"-200 mm	3,500
212-225 mm	5,800

Connecting thread	Size		Clamping range [mm]	Part no.	Sales unit	Pack unit	Dimensions [mm]					
	[inch]	[mm]					B	b1	H1	H	V	
M8/M10	3⁄8		14–20	151466	100	pieces	64	23	55	35.5	M6 x 20	
	1⁄2		21–26	151467			71		61	38.5	M6 x 25	
	3⁄4		26–30	151468			75		65	40.5		M6 x 25
	1		31–38	151469			81		71	43.5		
	1¼		40–47	151471	91		81	48.5	M6 x 25			
	1½		48–54	151472	100		89	52.5		M6 x 25		
		57	54–60	151473	105		94	55.0			M6 x 25	
	2		60–66	151474	111		100	58.0				M6 x 25
		70	68–73	151476	126		109	62.5	M8 x 35			
	2½		73–80	151477	131		114	65.0		M8 x 35		
		83	82–87	151478	142		124	70.0			M8 x 35	
	3		87–94	151479	146		128	72.0				M8 x 35
		102	99–104	151480	157		139	77.5	M8 x 35			
		110	105–112	151481	166		148	82.0		M8 x 35		
	4		112–118	151482	172		154	85.0			M8 x 35	
		125	122–128	151483	182		164	90.0				M8 x 35
		133	132–137	151484	191		173	94.5	M8 x 35			
	5		137–142	151485	196		178	97.0		M8 x 35		
		144	142–148	151486	202		184	100.0			M8 x 35	
		150	149–156	151487	210		192	104.0				M8 x 35
		160	159–164	151488	218		200	108.0	M8 x 35			



Single bossed clamps can be produced in all other pipe sizes and types according to customer specifications. For use in areas with requirements on the duration of fire resistance, the boundary conditions set out in the fire test report must be observed.

Single bossed clamps with DÄMMGULAST® blue, galvanised

Connecting thread	Size		Clamping range [mm]	Part no.	Sales unit	Pack unit	Dimensions [mm]				
	[inch]	[mm]					B	b1	H1	H	V
M10/M12	⅜		14–20	151491	100	pieces	64	23	60	40.5	M6 x 20
	½		21–26	151492			71		66	43.5	M6 x 25
	¾		26–30	151493			75		70	45.5	
	1		31–38	151494			81		76	48.5	
	1¼		40–47	151496	50		91		86	53.5	
		57	54–60	151498			105		99	60.0	
	2		60–66	151499			111		105	63.0	
		180	177–183	151516	25		235	28	223	122.0	M10 x 40
		200	197–203	151517			256		243	132.0	
		212	208–214	151518			284	46	256	138.5	
	8		217–225	151519			295		267	144.0	
		225	225–232	151520			304		274	147.5	



Single bossed clamps can be produced in all other pipe sizes and types according to customer specifications. For use in areas with requirements on the duration of fire resistance, the boundary conditions set out in the fire test report must be observed.