

### MPR-Diagonal struts type S+ galvanised

#### Field of application

- Supporting strut for reinforcement of corner joints in structures made of MPR-Support channels and MPR-Connection lock type S+
- For indoor use
- Also suitable for lateral support of consoles, e.g. for use with fixed points

#### Advantages

- Easily connected with the MPR-Support channels due to installation with the MPR-Connection lock type S+
- Various lengths available for different on-site installation conditions

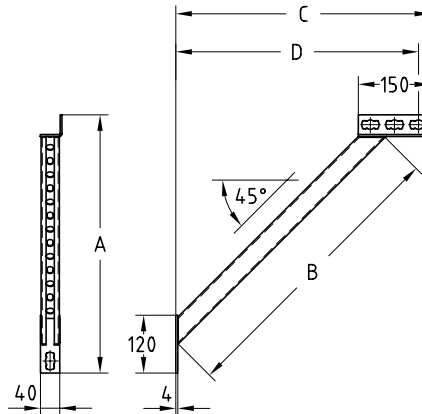

#### Features

	Length [mm]	Mounting of bracket and diagonal strut in the support channel slot max. recommended load F [N]
	440	2,500
	900	2,000

For support channels	Length [mm]	Part no.	Sales unit	Pack unit	Dimensions [mm]			
					A	B	C	D
41/41-41/124	440	165816	1	pieces	395	440	380	355
	900	165818			741	900	734	709