

MPR-Support channel without rear perforation, hot-dip galvanised

Field of application

- Installation of floors and piping systems in the technical areas of ships

Advantages

- Fast and easy installation on site of pipes and floor plates
- High flexibility of system, as disassembly for maintenance work or subsequent adjustments is possible
- System can be combined with attachment parts from MPR, MPR type S and MPR type S+
- Channel slot ensures simple connection of system components
- Hot-dip galvanised design of channels ensures rapid installation, as there is no need for paint work after installation

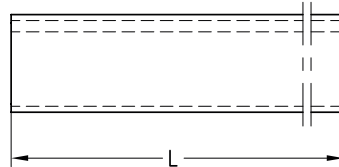
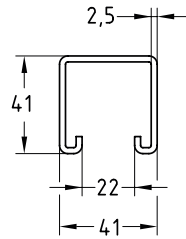

Profile	Length [mm]	Part no.	Sales unit	Pack unit
41/41/2.5	3,000	166723	1	pieces

